

LumensTM

www.MyLumens.com

Tap  **Share**TM

Quick Start Guide

Important

- * Please activate your warranty at www.MyLumens.com/reg
- * To download the latest version of the quick start guide, multilingual user manual, software, or driver, etc., please visit Lumens™ <http://www.Mylumens.com/support.php>
- * To ensure a successful installation, please be sure to follow each step.



Product



Manual

Installation

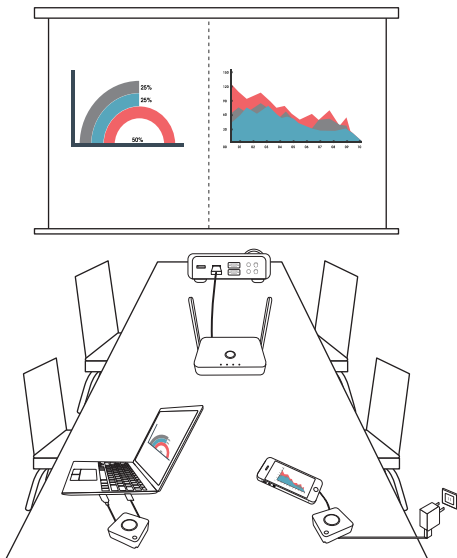

TapShare Box

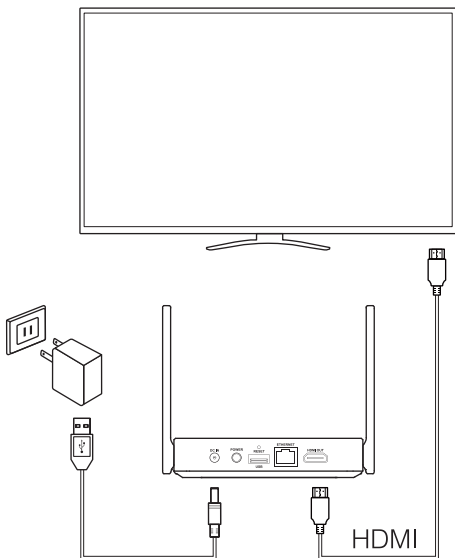

TapShare Pod

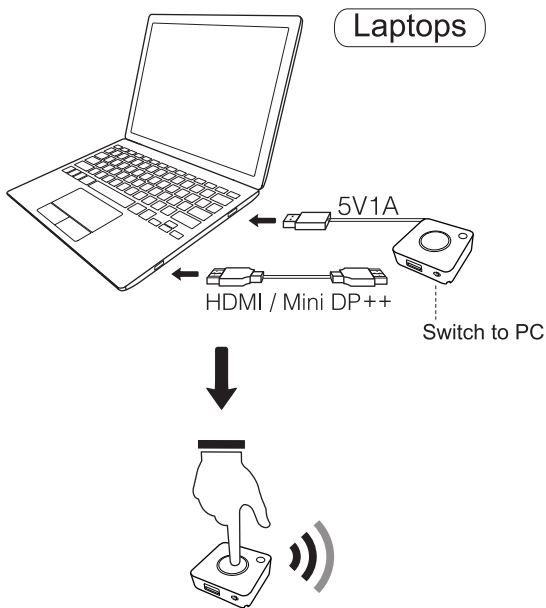

iOS

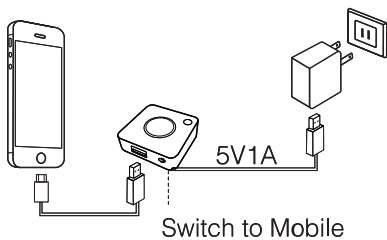

Projection from a Guest TapShare Pod

- The host presenter is the first pod connection followed by one or more guest pod presenters.
- "Host" is the first connection and rest is the "Guest".

Guest TapShare Pod

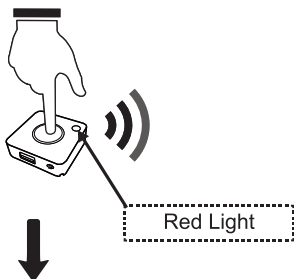

Host TapShare Pod

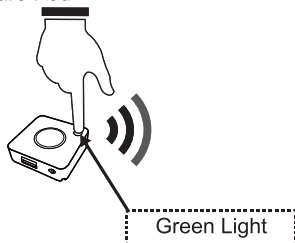

Pairing

- **Pairing for any new TapShare Pod or using ethernet connection**

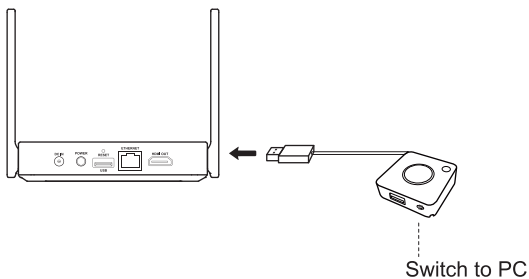

Pairing is done when the screen shows "Pairing OK"

Android

 **Please enable USB debugging before using.**

1. Go to Setting→System→About Phone

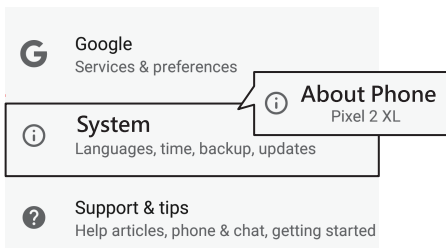

2. Click Build Number for 7 times to enable Developer Option

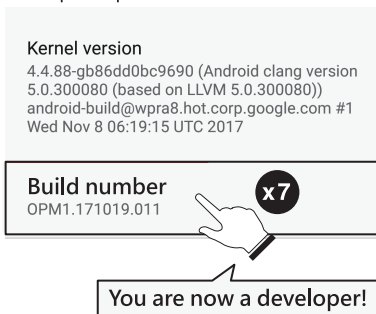

3. Go to Developer option→USB Debugging→ On

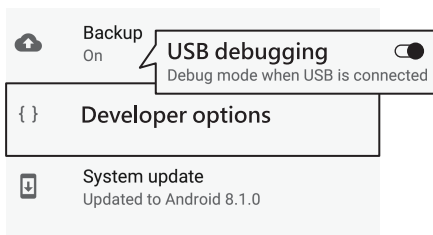

4. Plug to TapShare Pod transmitter and Allow USB debug

*Note: Please select MTP or File Transferring in the notifications when USB is connected.

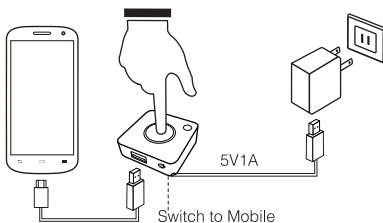

TapShare Pod LED Status list



Enable Host without source input



Host standby without casting



Enable Host and casting



Host received request of cast



Pairing done



1. Under connection
2. Pairing/Transmitter OTA download and installation
3. Fail to connection(blinking for 1minutes or more)



Enable Guest without source input



Guest standby without casting



Enable Guest and casting



Guest requests casting and wait for allow



Transmitter OTA Completed



Transmitter OTA Fail