

VC-WM15 Installation Guide

1. Package Contents

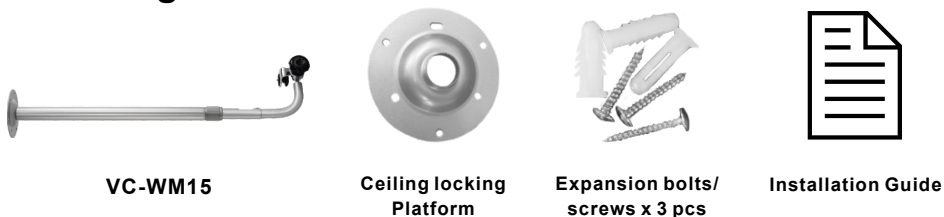

2. Product Function Descriptions

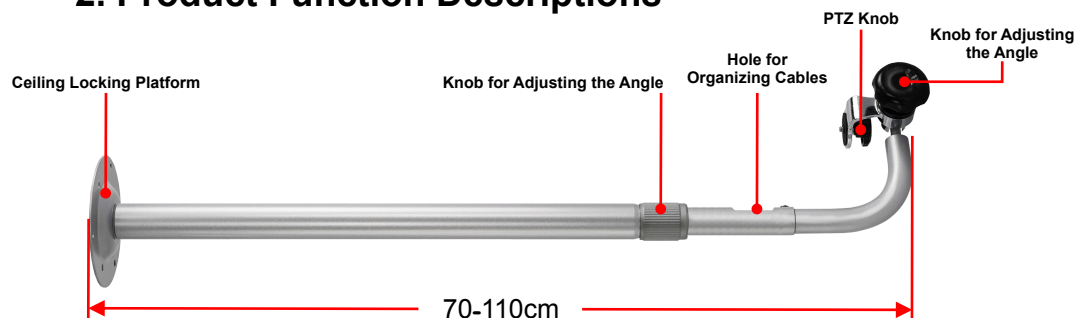

3. Precautions for installation

- 3.1 Load Capacity: 3 Kg
- 3.2 To install by yourself, please follow the installation procedures steps by steps, ensure steady and tight installation of the device.
- 3.3 Ensure the safety of the installation environment. Please do not install the bracket on unstable ceiling or in a place where the device is in danger of falling to avoid any accident.
- 3.4 It is recommended that two person perform the installation.
- 3.5 For the size diagram, please go to [Lumens website > Support > Download](https://www.MyLumens.com/Support) Area <https://www.MyLumens.com/Support>

4. Instruction for installation steps

4.1 To install Ceiling locking Platform

Use *3 pcs of expansion bolts and screws to install the ceiling locking platform on the ceiling

- * For mounting 3 pcs screws, please refer to the corresponding location of A and B in the figure below. Please do not mount arbitrarily to prevent from insecure installation
- * Pass through cables from the center hole of the ceiling locking platform and the bracket. Due to the aperture limitation of HDMI/RS-232/SDI cables, they are not suggested to pass through the the bracket for organizing cables

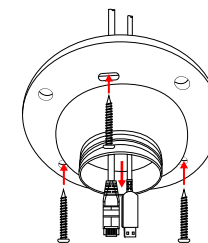
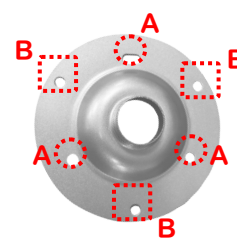

4.2 Screw the bracket into the platform for security

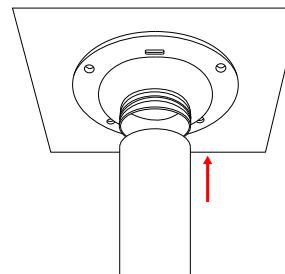

4.3 Mount the Camera

Secure the PTZ knob and the hole beneath the camera firmly

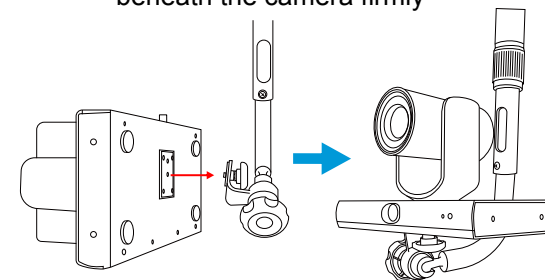

4.4 Adjust the bracket height and the angle of the camera

→Adjust the bracket height: After rotating the regulating ring and the bracket, they can stretch up and down for height adjustment

* After adjustment, be sure to tighten the regulating ring firmly to mount the height

→Adjust the angle of the camera: Knob for adjusting the angle is used to adjust the tilted angle

